

# KLH30RT85K4FI OR KLH40RT85K5FI OR KLH48RT85K6FI



### Features

- \* Double LED lines design, integrated design save- extra fixture and labor cost, IP65 rating.
- \* LM-80SMD as lighting-source. 120LPW, CRI>82Ra, R9>6
- \* Aluminum body as heat sink
- \* Built-in driver; PF>0.95.
- \* Long Lifetime, more than 50,000 hours.
- \* Damp and dry locations
- \* Integrated use: connection in series
- \* Beam Angle is 270 degrees

### Technical Characteristics

Color Temp:	5000K	Lens	Clear/Frosted
CRI	>80	PFC	>0.9
Lumen	115lm/W - 125lm/W	Life time	50000 hours
Input Power	30W if 4' & 40W if 5' & 48W if 6'		
Beam Angle	130°		
Input Voltage	100-277VAC/50-60Hz		

### Application:

- Coolers
- Freezers etc.

Housing Color: White



### Technical Specifications

#### Listings

ETL Listed  
DLC Listed



#### Others

#### Warranty time: 3 years

To prevent injury or damage to property, this product must be installed in accordance to National Electrical Code (NFPA70) in the US or Canadian Electrical Code (CSA 22.1) in Canada.

Risk of fire or electric shock. The electrical rating of these products are 100-277 Vac, the installer must determine whether they have 100-277 V at the luminaire before installation.

Risk of fire or electric shock. Installation requires knowledge of luminaires electrical systems. If not qualified, do not attempt installation. Contact a qualified electrician.

To prevent wiring damage or abrasion, do not expose wiring to edges of sheet metal or other sharp objects.

Disconnect power before installing the product or servicing it.

Wait until fixture has cooled down before installing or servicing the fixture.

Min. 90°C Supply Conductors

Warranty Period assumes that the Products are operated for less than 8 hours per day.

#### Dimension

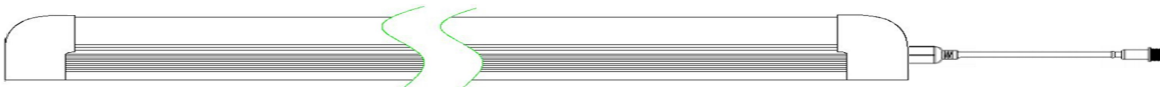

L=4FT=1200 mm  
L=5FT=1500 mm  
L=6FT=1800 mm  
L=8FT=2400 mm

# KLH30RT85K4FI OR KLH40RT85K5FI OR KLH48RT85K6FI



## Order Information

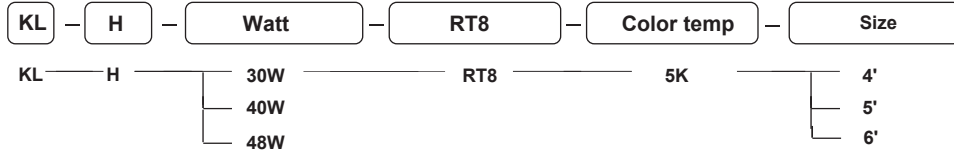

KL - H -  -  -  -

## Accessories

T shape extension cord

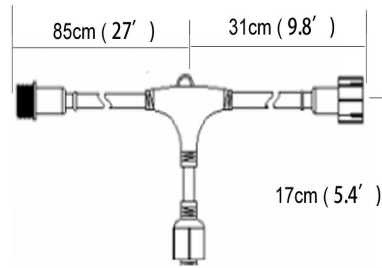

Metal clips

All metal clips will package on back

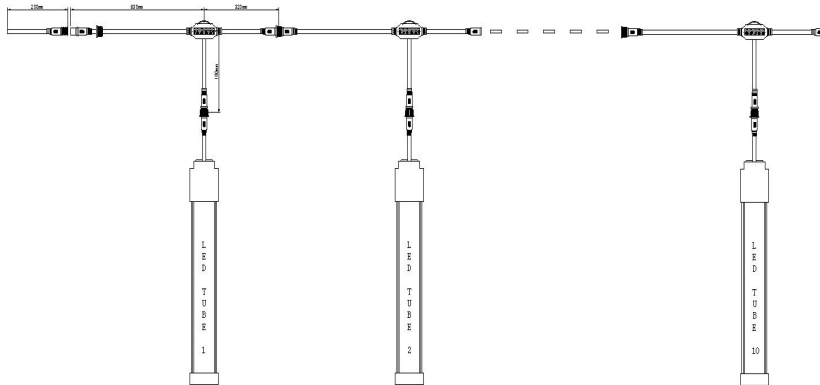

# KLH30RT85K4FI OR KLH40RT85K5FI OR KLH48RT85K6FI



## Parameters:

Model	Wattage	Size	Input Voltage	Operation Condition	IP Grade	Max Connection (@120Vac)	Max Connection (@220Vac)
KLH30RT85K4FI	30W	4FT/1200mm	100-277Vac, 50/60HZ	-20°C~40°C	IP20	9PCS	16PCS
KLH40RT85K5FI	40W	5FT/1500mm	100-277Vac, 50/60HZ	-20°C~40°C	IP20	7PCS	13PCS
KLH48RT85K6FI	48W	6FT/1800mm	100-277Vac, 50/60HZ	-20°C~40°C	IP20	6PCS	12PCS

Basic Specification	
Driver	Built-in
PF	0.9
Body Material	Aluminum
Cover Material	PC cover(clear/frosted)
Lifespan	50000hrs
Warranty	3Years

Photometric	
LED	LM-80 2835SMD
Luminance	>125LPW(clear PC)
	>115LPW(frosted PC)
CRI:82Ra	R9: 6
CCT	2700K-6500K
Beam angle	130°

Model No.	PCS/CTN	GW/CTN	Carton Size
KLH30RT85K4FI	25 units / CTN	10 kgs / CTN	1315*202*207mm
KLH40RT85K5FI	25 units / CTN	12 kgs / CTN	1550*20*207mm
KLH48RT85K6FI	25 units / CTN	14 kgs / CTN	1850*20*207mm

# KLH30RT85K4FI OR KLH40RT85K5FI OR KLH48RT85K6FI



## ⚠️ WARNING ⚠️

WARNING:

RISK OF ELECTRICAL SHOCK. TURN OFF POWER BEFORE INSTALLING, REMOVING OR INSPECTING. WARNING:

ALL WIRING TO BE PERFORMED IN ACCORDANCE WITH ELECTRICAL CODE AND LOCAL ELECTRICAL CODE

WARNING:

RISK OF FIRE. FIXTURES ARE RATED FOR USE IN 100-277Vac, 50-60HZ PROTECTED CIRCUIT AND 90°C RATED SUPPLY WIRE.

WARNING:

RISK OF CUT. THE ENCLOSED PRODUCT MAY HAVE SHARP EDGES, WEAR GLOVES TO PREVENT CUTS WHEN HANDLING, REMOVING, INSTALLING AND MAINTAINING THIS PRODUCT.

## Installation Guide:

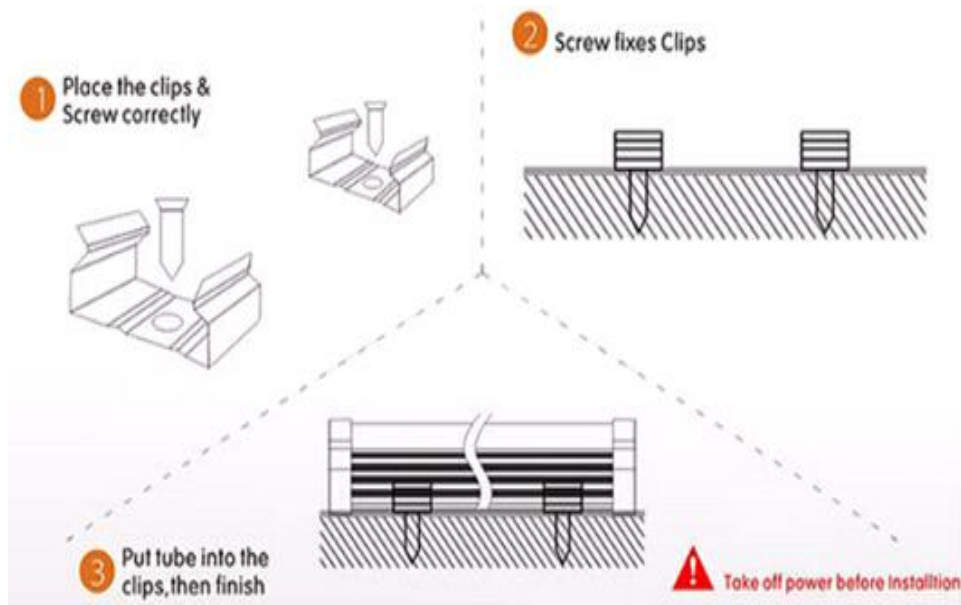

# KLH30RT85K4FI OR KLH40RT85K5FI OR KLH48RT85K6FI



## Structure:

